

Releasable chassis clamp

Features

- Can be removed from mounting side for easy disassembly.
- Round mounting hole allows easy fastening and unfastening of clamp.



Push Type



Round hole

Material

- Nylon 66 (Color : Natural)

UL94 V-0

RBWS-S

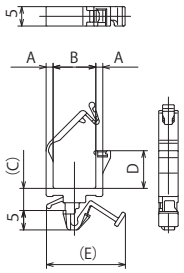

RBWS-N

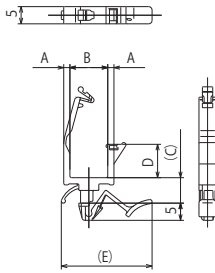

Part No.	A	B	(C)	D	(E)	Mounting hole size	Panel thickness	Std. Package
RBWS-3S VO	1.8	11	5.7	9.7	20.4	$\phi 4.8^{+0.2}$	0.5~1.6	1,000 pcs.
RBWS-1N VO	1.5		7.1	(5.2)	26.51		0.5~3.2	
RBWS-3N VO	1.8	7.4		9.7	26.39			
RBWS-5N VO			(15.5)	29.97	500 pcs.			
RBWS-8N VO	2.0	16.5	(22.5)	30.17				

...UL1565 recognized product

(Unit : mm)