

Unit: mm

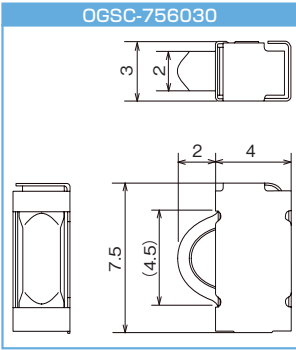

Unit: mm

Automated mounting applicable component for grounding with side-contact on PC board.

Feature

- Side-contact is applicable on PC board edge against chassis.
- Grounding contact is applicable between mother PC board and vertically placed daughter board.
- OGSC-402030: Down-sized compact design has been reduced by 80% of foot print area on PCB compared with existing part.
- OGSC-756030: Structure resists deformation even during lateral sliding.

Material

- Phosphor bronze for spring (Sn reflow plating)

Characteristics between Compression Force and Resistance

OGSC-402030

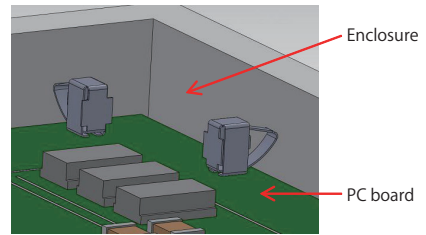
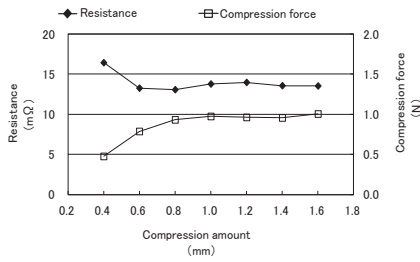

OGSC-756030

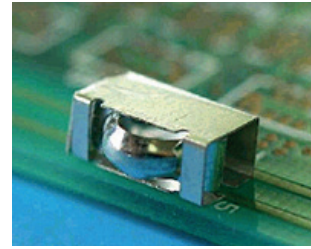
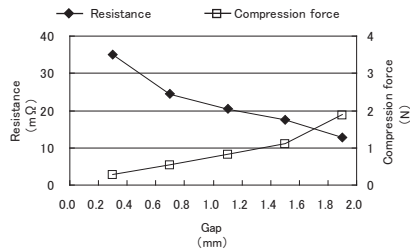

※The values are measured data for reference, not guaranteed.