

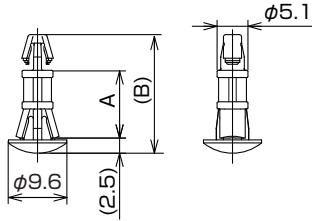

KGLS-RTBM V0

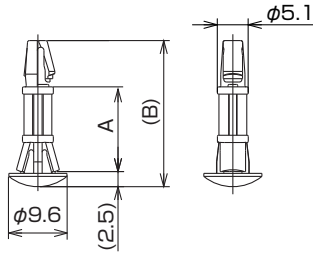

KGLS-14RTBM



Dome-head, snap-mount spacer for thin panel or thin back plate

Features

- Applicable thickness of sheet metal is at 0.4 to 1.2mm.
- Applicable thickness of PC board is for 1.6mm and 1.2mm.
- Dust resistant performance is performed by bowl shaped snap mounted from chassis bottom.

Material

- Nylon 6 (Color : Natural)
- Nylon 66 (Color : Natural)

UL94 V-0 : KGLS-8, 10, 12RTBM V0

UL94 V-0 : KGLS-3.5, KGLS-5, 6RTBM V0

UL94 V-2 : KGLS-14RTBM

Part No.	A	(B)	Mounting hole size	Panel thickness	Std. Package
KGLS-3.5 RTBM V0	3.5	11.9	Top $\phi 4^{+0.2}$ Bottom $\phi 5.5^{+0.2}$	Top 1.2~1.6 Bottom 0.4~1.2	100 pcs.
KGLS-5RTBM V0	5	13.4			
KGLS-6RTBM V0	6	14.4			
KGLS-8RTBM V0	8	16.4			
KGLS-10RTBM V0	10	18.4			
KGLS-12RTBM V0	12	20.4			
KGLS-16RTBM V0	16	24.4			

(Unit : mm)

Part No.	A	(B)	Mounting hole size	Panel thickness	Std. Package
KGLS-14RTBM	14	24.15	Top $\phi 4^{+0.2}$ Bottom $\phi 5.5^{+0.2}$	Top 1.2~1.6 Bottom 0.4~1.2	100pcs.

(Unit : mm)