

Large, screw mount clamp with an adjustable arm

Features

- U structured clamp holds cables from below with the keeper bar pushed down to fasten them. Adding or removing cables is easy.

Material

- Nylon 66 (Color : Natural)

UL94 V-2



Screw mounting

(Applicable screw: Nominal diameter 4mm
Small flat head or oval head screw)



Round hole

※ Specifications are described in the table below.

Specification drawing

Clamp

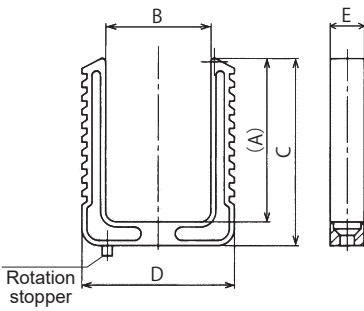

Keeper Bar

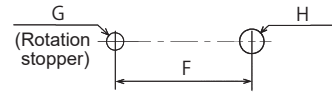
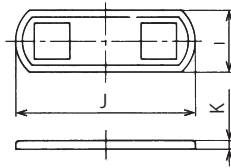

Part No.	(A)	B	C	D	E	F	G	H	I	J	K	Std. Package
KC-1830	30	18	37	31	8	9±0.1	φ3.4 ^{+0.1} ₀	φ4.3±0.1	15	40	2.25	100 pcs.
KC-3148	48	31	55	45	10	15±0.1	φ3.1 ^{+0.1} ₀		18	53	2.5	

(Unit : mm)