

EMC grounding function is added to the spacer whose specialty lever system enables easy fixing and removal of PC board.

**Feature**

- Easy fixing, opening and closing of PC board are provided as well grounding function.
- The flux which is on the metal contact surface on the chassis side can be removed when fixing.
- High workability and reduction of part numbers enable total cost downsizing.

**Material**

- Plastic portion / PA66 (Color: Black / Flammability: UL94V-0)
- Metal portion / Phosphor bronze (Sn reflow plating)

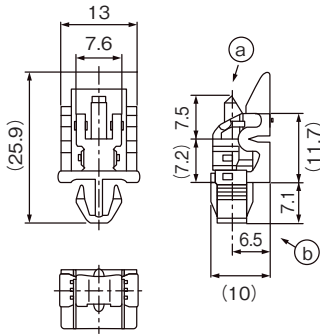

**Installation specifications**

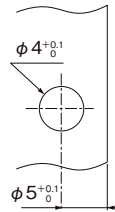

Ⓐ Board side :  $t1.6 \pm 0.15$

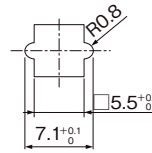

Ⓑ Chassis side :  $t0.8 \sim 2.3$

Unit:mm