



Accessory that mounts onto aluminum frame for band, clamp, and fastener

**Features**

- It enables fixing by being inserted into aluminum frame and rotated.
- Fixing is performed by cable tie inserted into back and forth and around it.
- Installation of fastener such as clamp is possible onto the top face.

**Material**

- Polypropylen (Color : Natural)

**How to mount onto Aluminium frame**

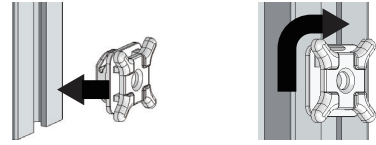

- ① Product is inserted into Aluminium frame groove.
- ② Installation by a 90-degree rotation

**Application**

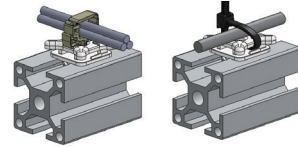

※ Rotating installation around clockwise and counter clockwise are available.

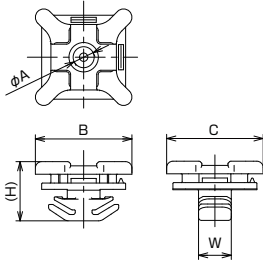

**Installation Specifications (Applicable frame profile)**

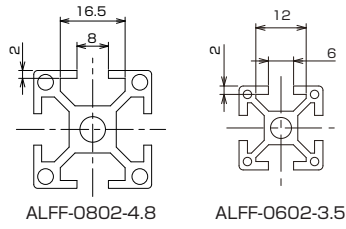

■ Aluminium frame length : 30mm and over Cable tie

Part No.	A	B	C	(H)	W	Applicable fastener specifications			
						Cable tie Width	Cable tie Thickness	Mounting hole diameter	Panel thickness
ALFF-0802-4.8	5	23	23	14.1	7.8	≤7.4mm	≤1.9mm	φ 4.8	2.0
ALFF-0602-3.5	3.5	16	16	11.1	5.8	≤5.2mm	≤1.6mm	φ 3.5	1.6

(Unit : mm)